

HOW TO ADD P163 OR P164 PRINTERS TO YOUR PERSONAL LAPTOP

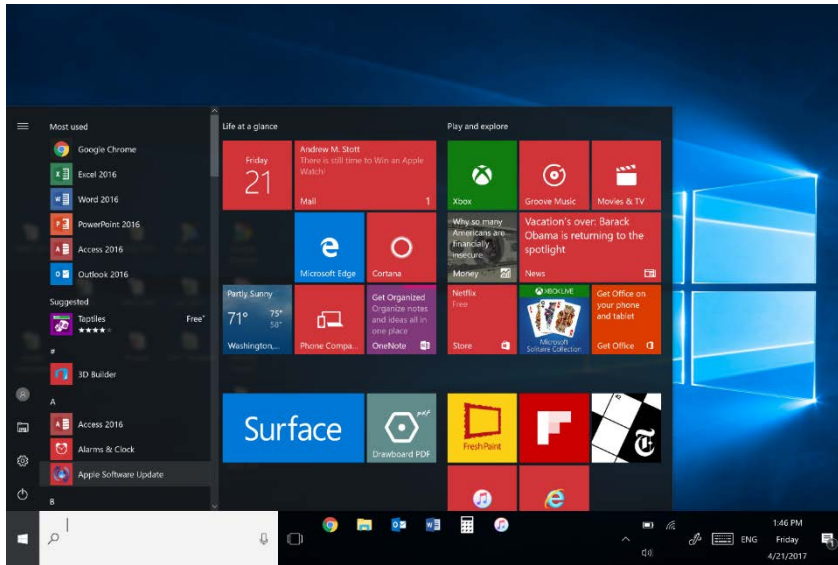

OPEN THE START MENU FROM
YOUR PERSONAL LAPTOP

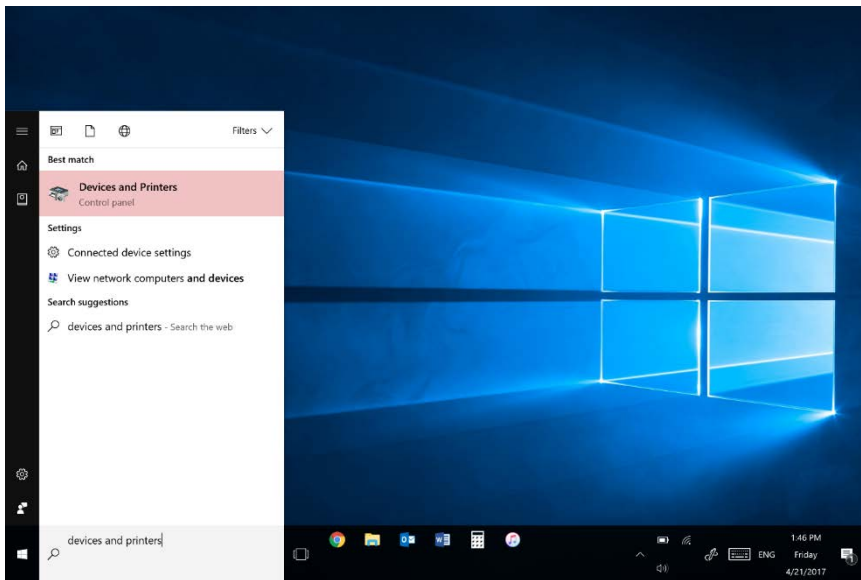

TYPE IN 'DEVICES AND PRINTERS'
INTO THE TEXT FIELD

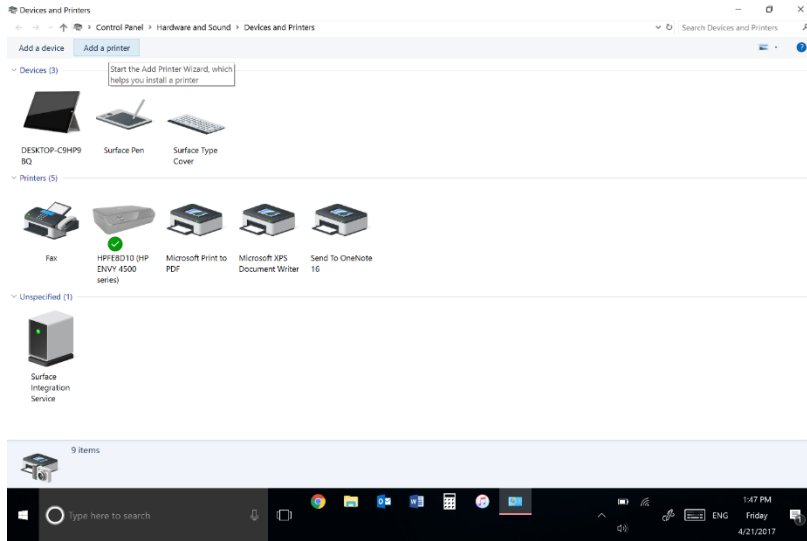

WHEN IN DEVICES AND PRINTERS,
IN THE TOP LEFT CORNER YOU WILL
SEE A BUTTON THAT SAYS 'ADD A
PRINTER'

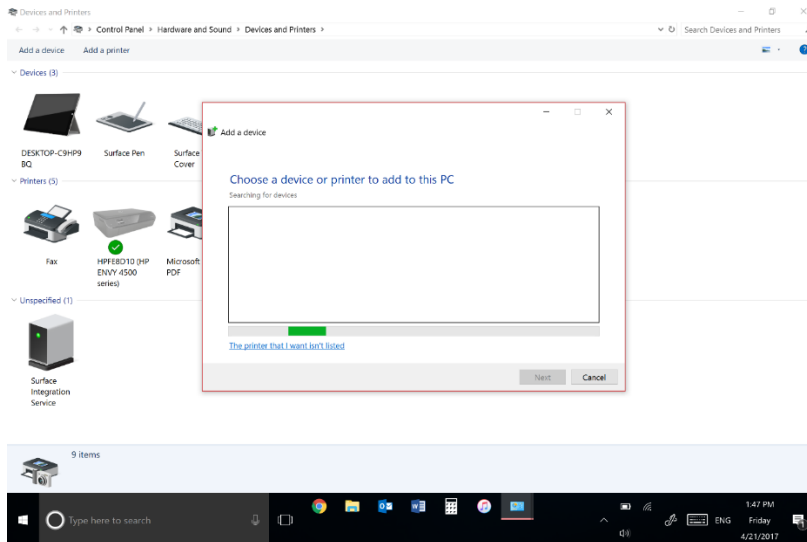

AFTER YOU CLICK IT, SELECT THE
OPTION 'THE PRINTER THAT I WANT
ISN'T LISTED'

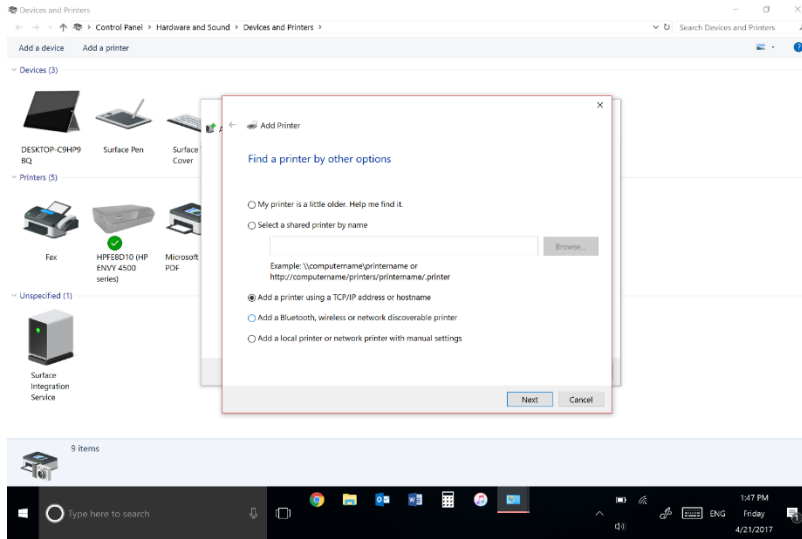

CLICK THE OPTION TO ADD USING
THE TCP/IP ADDRESS

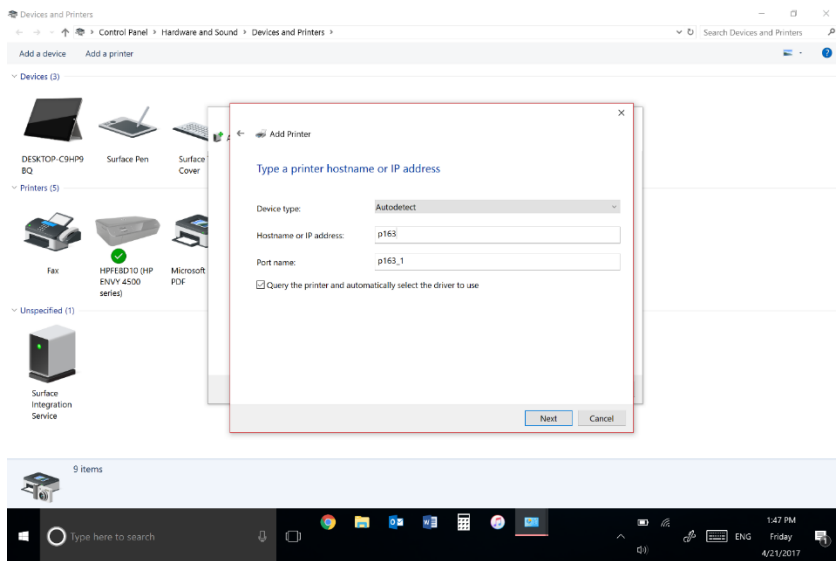

IN THE HOSTNAME BOX, TYPE IN THE
NAME OF THE PRINTER---
P163.OT.BUFFALO.EDU,
OR
P164.OT.BUFFALO.EDU,
AND CLICK NEXT

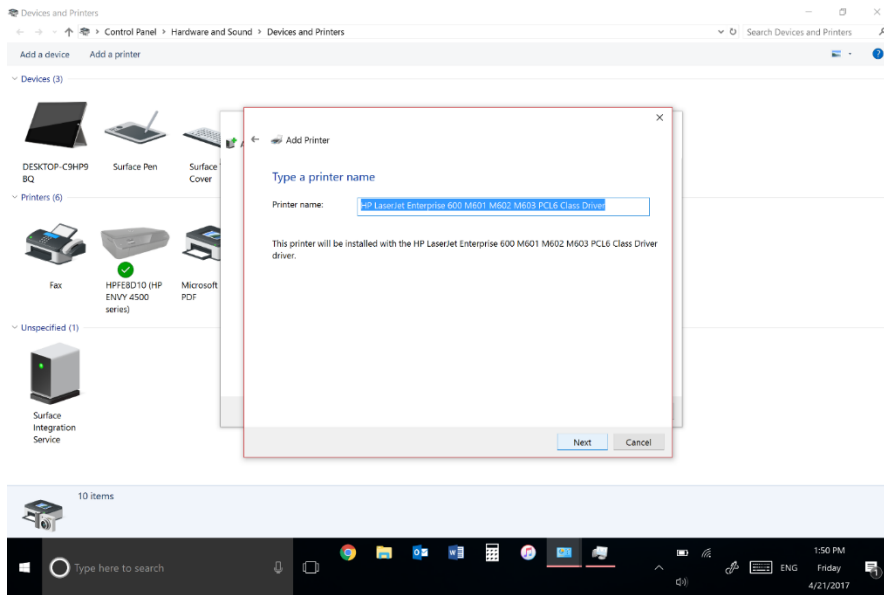

AFTER THE PRINTER IS ADDED,
CLICK NEXT WHEN PRESENTED
THIS OPTION. YOU CAN NAME
THE PRINTER WHAT EVER YOU
WANT.

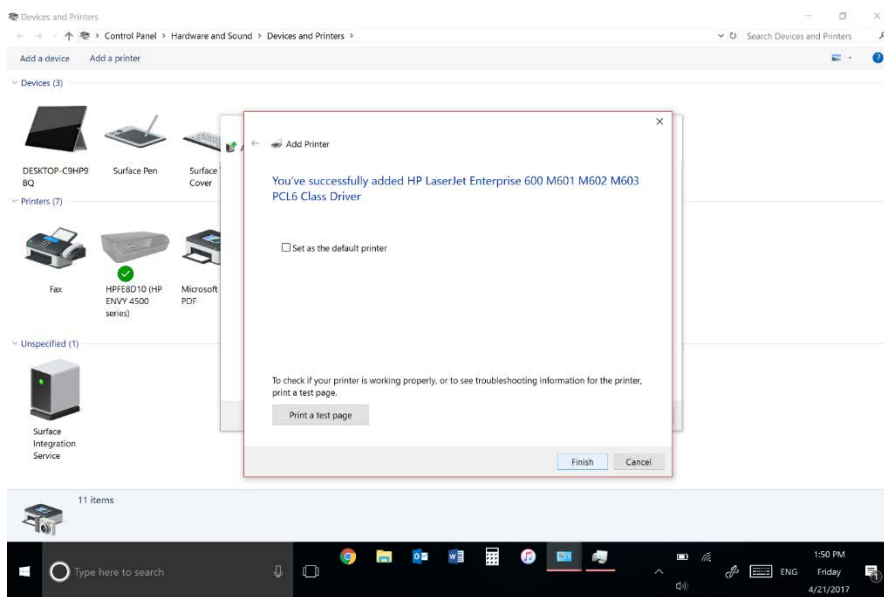

FINISH PRINTER INSTALLATION

THE PRINTER WILL NOW LABELLED AS THE NAME YOU SET
IT AS. IT WILL APPEAR UNDER PRINTERS AND DEVICES.